



1" DRIVE SOCKETS

1" Drive Standard Sockets, Chrome Finish, 12-pt., SAE



Product Code	UPC 662459+	Socket Size in.	Type	A	B	C	D	E	Bolt Clearance		Lbs.	Kgs
									Dia.	F		
X-1234	240361	1-1/16	I	2-1/4	2	1-5/8	3/4	1-1/16	13/16	1-15/32	1.23	.56
X-1236	240378	1-1/8	I	2-1/4	2	1-3/4	3/4	1-1/16	13/16	7/8	1.28	.58
X-1240	240385	1-1/4	I	2-3/8	2	1-7/8	3/4	1-1/8	13/16	7/8	1.26	.57
X-1242	240392	1-5/16	III	2-1/2	2	2-1/16	13/16	1-9/32	15/16	1-9/16	1.46	.66
X-1244	240408	1-3/8	III	2-1/2	2	2-1/8	7/8	1-11/32	1-25/64	1-9/16	1.40	.64
X-1246	240415	1-7/16	III	2-5/8	2	2-3/16	1	1-15/32	1-31/64	1-11/16	1.54	.70
X-1248	240422	1-1/2	III	2-3/4	2	2-1/4	1	1-19/32	1-9/16	1-13/16	1.64	.74
X-1252	240439	1-5/8	III	2-7/8	2	2-3/8	1-1/8	1-3/4	11/16	1-15/16	2.34	1.06
X-1258	240446	1-13/16	III	3-1/8	2-1/8	2-5/8	1-1/4	1-31/32	1-7/16	2-3/16	2.88	1.31
X-1260	240453	1-7/8	III	3-1/4	2-1/8	2-3/4	1-7/16	1-15/16	1-7/16	2-5/16	2.47	1.12
X-1264	240460	2	III	3-3/8	2-1/8	2-15/16	1-1/2	2-1/4	1-7/16	2-7/16	2.08	.94
X-1268	240477	2-1/8	III	3-1/2	2-1/4	3-1/8	1-1/2	2-11/32	1-7/16	2-9/16	2.36	1.07
X-1270	240484	2-3/16	III	3-5/8	2-1/4	3-1/8	1-17/32	2-1/4	2-1/4	2-11/16	2.52	1.14
X-1272	240491	2-1/4	III	3-3/4	2-1/4	3-1/4	1-5/8	2-5/16	2-21/64	2-7/32	2.72	1.23
X-1276	240507	2-3/8	III	3-7/8	2-1/4	3-3/8	1-5/8	2-3/4	2-23/64	2-1/16	2.78	1.26
X-1280	240514	2-1/2	III	4-1/8	2-1/4	3-1/2	1-3/4	2-11/16	2-1/2	3-1/16	3.32	1.51
X-1282	240521	2-9/16	III	4-1/8	2-1/4	3-9/16	2-13/16	2-3/4	2-9/16	3-3/16	3.44	1.56
X-1284	240538	2-5/8	III	4-1/4	2-1/4	3-5/8	1-7/8	2-3/4	2-39/64	2-25/64	3.30	1.50
X-1288	240545	2-3/4	III	4-1/2	2-1/4	3-3/4	2	3	2-3/4	3-9/16	3.70	1.68
X-1294	240552	2-15/16	III	4-27/32	2-1/4	4	2-1/8	3-9/32	2-15/16	2-31/32	4.20	1.91
X-1296	240569	3	III	4-7/8	2-1/4	4-1/8	2-1/8	3-5/16	3	2-63/64	4.50	2.04
X-12100	240576	3-1/8	III	4-31/32	2-1/4	4-1/4	2-1/8	3-3/8	3-1/8	3-1/16	5.00	2.27

Fed. Spec.: ANSI B107.1

- Drilled hole in drive end provides positive and secure engagement needed for heavier sockets.

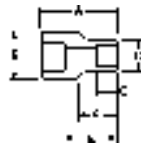

TYPE I



TYPE III



WARNING

- Wear safety goggles. (Users and bystanders)

